



AUSTLIFT®

G100 CHAIN & FITTINGS

LIFTING YOUR BUSINESS TO A HIGHER LEVEL

AUSTRALIAN LIFTING CENTRE PTY LTD

1300 100 120

www.austlift.com.au



G100 Chain & Fittings

G100 Alloy Chain	10
Master Link	10
Master Link Multi	11
Chain Connector	11
Grab Hook (Clevis, Eye)	12
Self Locking Hook (Clevis, Eye, Swivel)	13
Sling Hook (Clevis, Eye)	14
Shortening Clutch (Clevis)	15
Spare Parts	16
Chain Sling WLL Tag	16

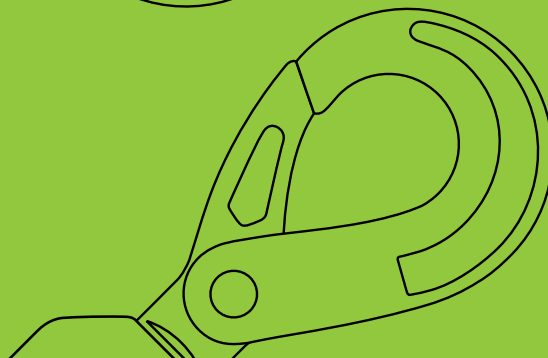
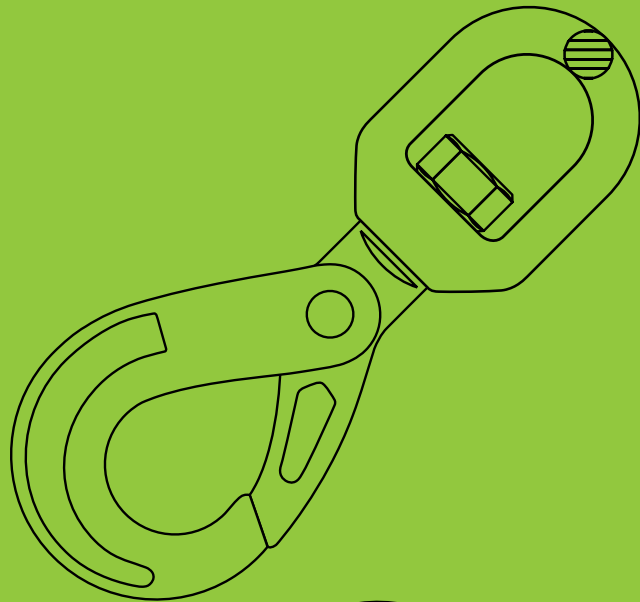



G100 Chain & Fittings

Austlift G100 products are manufactured and tested to the requirements of Australian Standard 2321 'short link chain for lifting purpose' and AS3776 'lifting components for Grade V chain slings' in extremely high quality.

All G100 products are made from alloy steel, the chemical composition conforms to EN 1677: 2000 specification. They are quenched and tempered, uniformly marked with equivalent chain size, grade, batch number, manufacturer's ID and product 'type code' for positive identification.

We regard your safety as our priority. Destructive tests are applied to every batch on a random sampling. Test certificates are available upon request.



Full Member

G100 Alloy Chain

Austlift G100 chain has a 25% higher lifting capacity than G80. The chain is manufactured from hardened and tempered alloy steels and has a high resistance to impact and wear to meet critical requirements of AS 2321 "short link chain for lifting purposes", but with 25% higher work load limit.

Chain links are formed to produce its high quality of strength, durability and safety of lifting chain applications.

- Marked with chain grade and traceability mark.
- Made of G100 alloy steel with safety factor of 4 to 1.

AS/NZS 2321	Certified	G100 Alloy Steel	Safety Factor 4-1	Size from (mm) 6-22
--------------------	------------------	-------------------------	--------------------------	----------------------------

SIZE (mm)	WLL (T)	DRUM		CUT LENGTH (IM)		DIMENSIONS (mm)		
		CODE	LENGTH (M)	CODE	Wt. (kg)	B	C	D
6	1.4	171106	625	171006	0.8	21	18	6
8	2.5	171108	350	171008	1.4	28	24	8
10	4	171110	250	171010	2.2	35	30	10
13	6.7	171113	130	171013	3.8	46	39	13
16	10	171116	100	171016	5.7	56	48	16
20	16	171120	60	171020	9	70	60	20
22	19	171122	25	171022	10.9	78	66	22

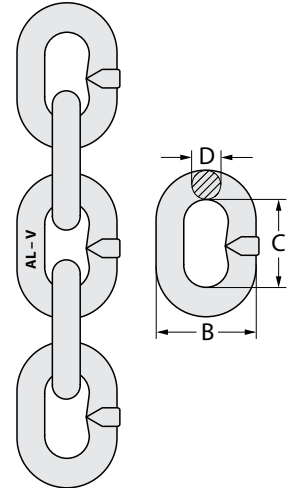

G100 Chain & Fittings

G100 Master Link (Type SD, with flat)

Austlift SD type G100 head-rings are designed to cater for single leg and double leg chain sling or wire rope sling applications.

- Marked with single and double chain sizes, designation, grade, manufacture quality mark and Austlift branded.
- 25% higher working load limit than G80 alloy chain.
- Batch Tested. Test certificates available upon request.
- Fatigue tested > 20,000 times.

AS/NZS 3776	Certified	G100 Alloy Steel	Safety Factor 4-1	Size from (mm) 8-32
--------------------	------------------	-------------------------	--------------------------	----------------------------

SUIT CHAIN SIZE (mm)		CODE	WLL (T)	Wt. (kg)	DIMENSIONS (mm)		
1 LEG	2 LEG				A	B	D
8	6	170008	2.5	0.4	120	70	13
10	8	170010	4.3	0.7	140	80	17
13	10	170013	6.9	1.5	160	95	22
16	13	170016	11.6	2.51	180	100	27
20	16	170020	17.3	5.1	240	140	32
22	20	170022	27.7	7.2	250	150	38
26	22	170026	32.9	7.86	250	150	40
32	26	170032	45.8	14.84	300	180	50

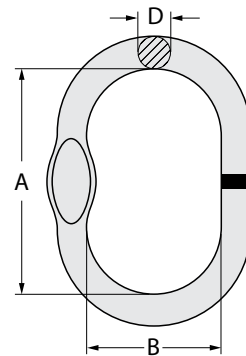

* Specification Chart for master Link WLL is 60 ° Angle for multi leg.

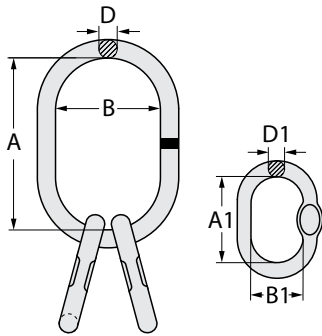

G100 Master Link Multi (Type MD, with flat)

Austlift MD type G100 multi head rings are designed with a large ring and two intermediate links to cater for two, three and four leg chain slings or wire rope slings applications.

- Marked with single and double chain size, designation, grade, manufacture quality mark and Austlift branded.
- 25% higher work load limit than G80.
- Batch tested, test certificates available upon request.
- Fatigue tested > 20,000 times.

AS/NZS 3776 Certified G100 Alloy Steel Safety Factor 4-1 Size from (mm) 6-32

SIZE (mm)	CODE	WLL (T)	Wt. (kg)	DIMENSIONS (mm)					
				A	B	D	A1	B1	D1
6	170106	3.5	1.8	90	150	19	70	120	14
8	170108	5	3.0	95	160	22	80	140	17
10	170110	8	6.5	120	200	30	95	160	22
13	170113	14	15	150	250	40	110	190	25
16	170116	21	23	200	300	50	120	200	32
20	170120	33.6	23.67	350	190	50	180	90	32
22	170122	39.9	26	350	190	50	180	100	36
26	170126	56	42.6	400	200	60	180	100	45
32	170132	85	66.7	460	250	72	200	110	50

Note: For 20mm and above, the sub rings are smaller in size.

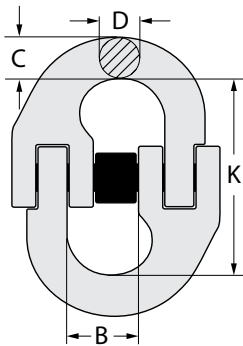

G100 Chain Connector (Type CL) Hammerlock / Coupler / Connector Link

Austlift CL type G100 chain connector are commonly used to connect head rings, chain, hooks and other lifting components for chain slings.

- Marked with chain size, designation, grade, manufacture quality mark and Austlift branded.
- 25% higher work load limit than G80.
- Batch tested, test certificates available upon request.
- Fatigue tested > 20,000 times.

Refer to page 16 for G100 spare parts information.

AS/NZS 3776 Certified G100 Alloy Steel Safety Factor 4-1 Size from (mm) 6-32

SIZE (mm)	CODE	WLL (T)	Wt. (kg)	DIMENSIONS (mm)			
				B	C	K	D
6	170206	1.4	0.08	16.9	8.5	44.5	7
8	170208	2.5	0.18	22.7	10.5	63	10
10	170210	4	0.34	27.7	12.6	71	12.6
13	170213	6.7	0.68	33.2	16.5	92.5	16.5
16	170216	10	1.22	39	20	106.5	20
20	170220	15.6	2.13	47.3	25	123	25
22	170222	19	3	55	27	137.5	27
26	170226	26.5	5.22	68	32	163	32
32	170232	40	9.55	87	40	197	40

G100 Grab Hook (Clevis Type, GC)

Austlift GC type G100 clevis grab hooks provide the flexibility to shorten chain leg on a sling may also be used for back-hooking. Grab hooks come with supporting lugs to allow no reduction of the working load limit. The clevis is designed for ease of connection of chain.

- Marked with chain size, designation, grade, manufacture quality mark and Austlift branded.
- 25% higher work load limit than G80.
- Batch tested, test certificates available upon request.
- Fatigue tested > 20,000 times.

 Refer to page 16 for G100 spare parts information.

AS/NZS 3776	Certified	G100 Alloy Steel	Safety Factor 4-1	Size from (mm) 6-32
--------------------	------------------	-------------------------	--------------------------	----------------------------

SIZE (mm)	CODE	WLL (T)	Wt. (kg)	DIMENSIONS (mm)					
				A	B	E	L	L1	M
6	170306	1.4	0.22	7.5	32	8	77.3	44.5	46.5
8	170308	2.5	0.34	9.5	36	11	93	53	54
10	170310	4	0.82	12.5	46	13.5	127	73	72
13	170313	6.7	1.75	15	59	15	164	92	96
16	170316	10	2.88	18.5	70	19	188	103	115
20	170320	16	4.84	24	85	25	223	123	145
22	170322	19	8.3	27	100	27	260	141	159
26	170326	26.5	13.72	30	110	34	320	187	190
32	170332	40	25.5	35	150	41	378	213	229

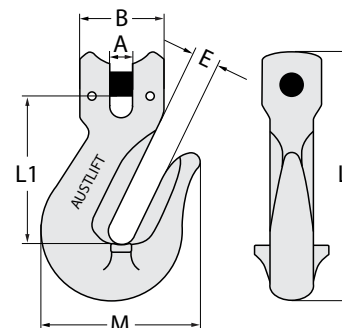

G100 Grab Hook (Eye Type, GE)

Austlift GE type G100 eye grab hook provide the flexibility to shorten chain leg on a sling may also be used for back-hooking. Grab hooks come with supporting lugs to allow no reduction of the working load limit. The eye is designed for ease of connection of coup-link.

- Marked with chain size, designation, grade, manufacture quality mark and Austlift branded.
- 25% higher work load limit than G80.
- Batch tested, test certificates available upon request.
- Fatigue tested > 20,000 times.

AS/NZS 3776	Certified	G100 Alloy Steel	Safety Factor 4-1	Size from (mm) 6-32
--------------------	------------------	-------------------------	--------------------------	----------------------------

SIZE (mm)	CODE	WLL (T)	Wt. (kg)	DIMENSIONS (mm)				
				D	E	M	L	L1
6	170406	1.4	0.15	13.5	8	46.5	73	46
8	170408	2.5	0.3	17.5	11	53	93	61
10	170410	4	0.79	22	13.5	74	129	85
13	170413	6.7	1.67	27	17	96	166	104
16	170416	10	2.74	36	19	116	186	119
20	170420	16	4.72	44	25	145	225	146
22	170422	19	8.2	48.5	27	160.5	260.5	165.5
26	170426	26.5	11.35	52	34	190	311	204
32	170432	40	20.65	64	41	229	373	246

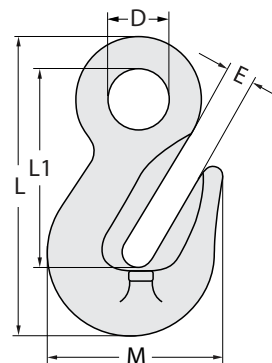

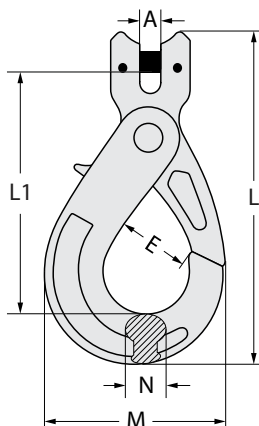

G100 Self Locking Hook (Clevis Type, LC)

Austlift LC type G100 clevis self-locking hook allows the hook to be easily closed with one hand, it will close itself when the load is engaged. The hook will not open until the trigger at the back is pressed. Clevis style allows easy connection to the chain.

- Marked with chain size, designation, grade, manufacture quality mark and Austlift branded.
- 25% higher work load limit than G80.
- Batch tested, test certificates available upon request.
- Spare trigger kits and load pins are available.
- Fatigue tested > 20,000 times.

Refer to page 16 for G100 spare parts information.

AS/NZS 3776 Certified G100 Alloy Steel Safety Factor 4-1 Size from (mm) 6-32

SIZE (mm)	CODE	WLL (T)	Wt. (kg)	DIMENSIONS (mm)					
				A	E	L	L1	M	N
6	170506	1.4	0.5	8	28	131	96	73	15
8	170508	2.5	0.9	9.5	36	163	121	90	20
10	170510	4	1.4	12	45	194	144	108	26
13	170513	6.7	2.9	15	53.6	251	182	137	32.5
16	170516	10	5.5	18.5	61	303	220	168	38
20	170520	16	8.6	25	76.5	337	235	190	50
22	170522	19	12.1	25.5	76	386	271	202	52
26	170526	26.5	21.15	30	99	484	343	251	60
32	170532	40	43.4	35	135	601	423	329	75

G100 Self Locking Hook (Eye Type, LE)

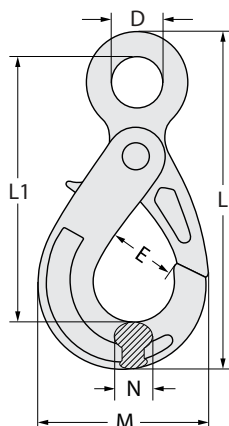

Austlift LE type G100 eye self-locking hook allows the hook to be easily closed with one hand, it will close itself when the load is engaged. The hook will not open until the trigger at the back is pressed. Eye style allows easy connection to links, shackles and wire.

- Marked with chain size, designation, grade, manufacture quality mark and Austlift branded.
- 25% higher work load limit than G80.
- Batch tested, test certificates available upon request.
- Fatigue tested > 20,000 times.

Refer to page 16 for G100 spare parts information.

AS/NZS 3776 Certified G100 Alloy Steel Safety Factor 4-1 Size from (mm) 6-32

SIZE (mm)	CODE	WLL (T)	Wt. (kg)	DIMENSIONS (mm)					
				D	E	L	L1	M	N
6	170606	1.4	0.5	21	28	141	110	73	15
8	170608	2.5	0.9	27	36	175	137	90	20
10	170610	4	1.5	34.5	45	212	170	108	26
13	170613	6.7	2.7	40	53.6	269	209	137.5	32.5
16	170616	10	5.7	50	61	333	256	170.5	38
20	170620	16	7.9	60	76.5	368.5	277	191.5	50
22	170622	19	11.2	70	76	417	319	205	52
26	170626	26.5	20.5	76	99	489	370	251	60
32	170632	40	40.35	95	135	620	469	329	75

G100 Self Locking Hook (Swivel Type, LS)

Austlift Grade 100 Swivel Self-locking Hook has a ball bearing swivel to allow the hook to swivel thus reducing the twist of a sling.

- Marked with chain size, designation, grade, manufacture quality mark and Austlift branded.
- 25% higher work load limit than G80.
- Batch tested, test certificates available upon request.
- Spare trigger kits are available.
- Fatigue tested > 20,000 times.

Refer to page 16 for G100 spare parts information.

AS/NZS 3776 Certified G100 Alloy Steel Safety Factor 4-1 Size from (mm) 6-32

SIZE (mm)	CODE	WLL (T)	Wt. (kg)	DIMENSIONS (mm)							
				B	C	D	H	K	L	N	W
6	173706	1.4	0.67	13.5	32.5	27	35	163	196	15	71
8	173708	2.5	1.21	15	41	35	40	203	244	21.5	90
10	173710	4	2.2	17.5	48	45	51	244	289	25.5	108
13	173713	6.7	4.4	19	55	53.6	59	295	354	32	138
16	173716	10	7.48	26	61	62	66	348	424	38	170
20	173720	16	13.75	28.5	76	76	76	399	489	50	191
22	173722	19	18.81	33	97	80	100	469	566	52	208
26	173726	26.5	31.4	42	123	100	119	565	688	60	253
32	173732	40	61.02	52	152	143	153	680	830	75	329

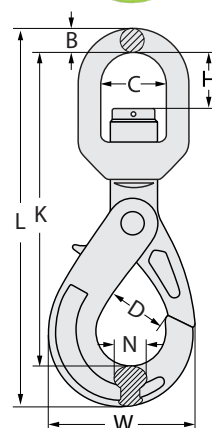

G100 Sling Hook (Clevis Type, SC, with Latch)

Austlift SC type G100 clevis sling hook are a general purpose hook suitable for most sling applications and comes with a cast latch for added safety. Clevis allows easy connection to chain.

- Marked with chain size, designation, grade, manufacture quality mark and Austlift branded.
- 25% higher work load limit than G80.
- Batch tested, test certificates available upon request.
- Fatigue tested > 20,000 times.

Refer to page 16 for G100 spare parts information.

AS/NZS 3776 Certified G100 Alloy Steel Safety Factor 4-1 Size from (mm) 6-32

SIZE (mm)	CODE	WLL (T)	Wt. (kg)	DIMENSIONS (mm)						
				A	B	E	H	M	L	L1
6	170806	1.4	0.33	7.5	32	17	21	68.5	109	73
8	170808	2.5	0.6	9.5	37	23	27.5	88	134	88.5
10	170810	4	1.3	12.5	48	29	32	102	160	105
13	170813	6.7	2.3	15	59	38	42	134	203	132
16	170816	10	3.6	18.5	70	46	50	160.5	248	161
20	170820	16	7.3	25	85	50	56	190.5	297	197
22	170822	19	12.1	27	100	65	62	214.5	326	214
26	170826	26.5	16.1	30.5	118	72	73	248	383	247
32	170832	40	27.2	37.5	149	87	87	281	474	310

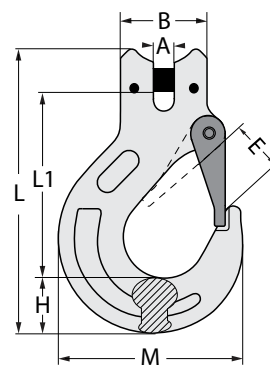

G100 Sling Hook (Eye Type, SE, with Latch)



Austlift SE type G100 eye sling hooks are a general purpose hook suitable for most sling applications and come with a cast latch for added safety. Eye allows easy connection to coup links and can be attached to lifting apparatus.

- Marked with chain size, designation, grade, manufacture quality mark and Austlift branded.
- 25% higher work load limit than G80.
- Batch tested, test certificates available upon request.
- Fatigue tested > 20,000 times.

Refer to page 16 for G100 spare parts information.

AS/NZS 3776 Certified G100 Alloy Steel Safety Factor 4-1 Size from (mm) 6-32

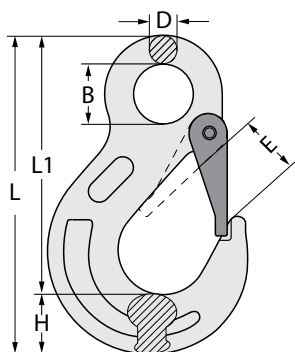

SIZE (mm)	CODE	WLL (T)	Wt. (kg)	DIMENSIONS (mm)					
				B	D	E	H	L	L1
6	170906	1.4	0.32	20.5	10	18.5	21	111	80
8	170908	2.5	0.6	25	11	25	27	137	99
10	170910	4	1.2	32	16	29.5	33	170	106
13	170913	6.7	2.2	43	19	38	43.5	219	156.5
16	170916	10	3.5	51	24.5	46	50	260	185.5
20	170920	16	6.2	55	27	50	56	298	215
26	170926	26.5	12.2	70	35	70	75	376	265
32	170932	40	17.5	81.5	39	82	89	458	331

G100 Shortening Clutch (Clevis Type, CC, safety pin)



Austlift CC type lockable clutches have the advantage of shortening a chain sling without loss of the working load limit of the sling. The clevis allows easy connection to chain. Not recommended for use as bottom fitting of sling for back-hooking and reeving applications.

- Marked with single and double chain size, designation, grade, manufacture quality mark and Austlift branded.
- 25% higher work load limit than G80.
- Batch tested, test certificates available upon request.
- Fatigue tested > 20,000 times.

AS/NZS 3776 Certified G100 Alloy Steel Safety Factor 4-1 Size from (mm) 6-16

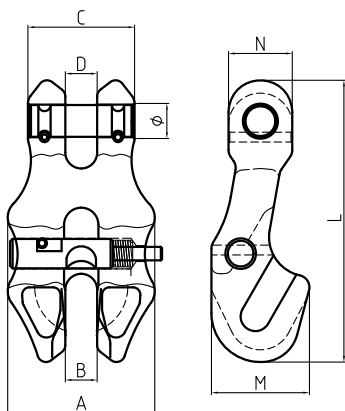

SIZE (mm)	CODE	WLL (T)	Wt. (kg)	DIMENSIONS (mm)							
				A	B	C	D	M	N	Ø	L
10	171210	4	0.75	60	11.7	43	11.7	45.4	26	13.3	115
13	171213	6.7	1.67	79	15	55	15	54	34	16.3	149
16	171216	10	4.2	98	19	70	19	70	40	19.7	184

Chain Sling WLL Tag

Austlift G100 safe work load tags are essential to identify a chain sling's lifting capacity together with other relevant information.

- Tags for single and multi lifting are available.
- Manufactured in 304 stainless steel material.

AS/NZS 3775 Certified 304 Stainless Steel Size from (mm) **8-22**

SIZE	CODE	
	SINGLE	MULTI
8	090108SP	090208SP
10	090110SP	090210SP
13	090113SP	090213SP
16	090116SP	090216SP
20	090120SP	090220SP
22	090122SP	090222SP



G100 Chain & Fittings

SPARE PARTS FOR G100 FITTING



Pin for Clevis Hook

SIZE (mm)	CODE	SUIT FOR PRODUCTS		
		CLEVIS SLING HOOK	CLEVIS SELF LOCK HOOK	CLEVIS GRAB HOOK
6	030606SP	SC-6-10	LC-6-10	GC-6-10
8	030608SP	SC-8-10	LC-8-10	GC-8-10
10	030610SP	SC-10-10	LC-10-10	GC-10-10
13	030613SP	SC-13-10	LC-13-10	GC-13-10
16	030616SP	SC-16-10	LC-16-10	GC-16-10
20	030620SP	SC-20-10	LC-20-10	GC-20-10
22	030622SP	SC-22-10	LC-22-10	GC-22-10



Safety Latch for Sling Hook

SIZE (mm)	CODE	SUIT FOR PRODUCTS	
		EYE	CLEVIS
6	030806SP	SE-6-10	SC-6-10
8	030808SP	SE-8-10	SC-8-10
10	030810SP	SE-10-10	SC-10-10
13	030813SP	SE-13-10	SC-13-10
16	030816SP	SE-16-10	SC-16-10
20	030820SP	SE-20-10	SC-20-10
22	030822SP	SE-22-10	SC-22-10



Pin and Stud for Chain Connector

SIZE (mm)	CODE	SUIT FOR PRODUCTS
6	030706SP	CL-6-10
8	030708SP	CL-8-10
10	030710SP	CL-10-10
13	030713SP	CL-13-10
16	030716SP	CL-16-10
20	030720SP	CL-20-10
22	030722SP	CL-22-10

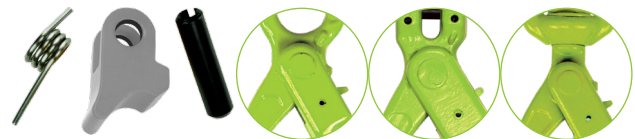

Safety Trigger Kit for Self Locking Hook

SIZE (mm)	CODE	SUIT FOR PRODUCTS		
		EYE	CLEVIS	SWIVEL
6	030106SP	LE-6-10	LC-6-10	LS-6-10
8	030108SP	LE-8-10	LC-8-10	LS-8-10
10	030110SP	LE-10-10	LC-10-10	LS-10-10
13	030113SP	LE-13-10	LC-13-10	LS-13-10
16	030116SP	LE-16-10	LC-16-10	LS-16-10
20	030120SP	LE-20-10	LC-20-10	LS-20-10
22	030122SP	LE-22-10	LC-22-10	LS-22-10