

Description

The Alemlube 1,200kg Lifting Table is a multi-angle and multi-direction lifting table providing a safe and efficient solution for under vehicle tasks such as engine transmission, hybrid battery and sub frame works to be carried out.

- Capacity 1,200kg
- Rest height 480mm
- Lifting height 1,810mm
- Platform width 770mm
- Platform length 1,300mm



Safety Warning and Precautions

WARNING: When using tools, basic safety precautions should always be followed to reduce the risk of personal injury and damage to equipment.

1. Keep work area clean. Cluttered areas invite injuries.
2. Observe work area conditions. Do not use machines or power tools in damp or wet locations. Don't expose to rain. Keep work area well lit. Do not use electrically powered tools in the presence of flammable gases or liquids.
3. Keep children away. Children must never be allowed in the work area, or to handle machines, tools or extension cords.
4. Study, understand, and follow all instructions before operating this device.
5. Wear eye protection that meets OSHA and ANSI Z87.1 standards.
6. Only qualified personnel shall perform inspections and repairs to this lift.
7. Before using lift, inspect the lift for bends, cracks, dents, elongated holes, or missing hardware. If damage is found, discontinue use.
8. Use only those repair parts called out in the parts list in this document. Items found in the parts list have been carefully tested and selected.
9. Do not exceed the rated capacity of lift or platform extension.
10. Do not raise or lower lift with platform extended.
11. Use only on a hard, level surface.
12. Do not raise or move a load having a center of gravity extending beyond the wheels. Tipping can result in personal injury.
13. Do not move lift while a load is raised. Carefully and slowly move the load on inclines or around corners. Tipping can result in personal injury. Lower the load completely before storage.
14. Do not stand under a load supported by the lift.
15. Secure component in place before removing it from the lift.
16. No alterations shall be made to this product as this will void the warranty.

Pump

1. Do not exceed the hydraulic pressure rating noted on the pump data plate or tamper with the internal high pressure relief valve. Creating pressure beyond the rated pressure can result in personal injury.
2. Before replenishing the fluid level, retract the system to prevent overfilling the pump reservoir. An overfill can cause personal injury due to excess reservoir pressure created when cylinders are retracted.

Unpacking

1. Cut the shipping banding from the carton and platform.
2. Install lift handle into the base frame weldment and secure in place with the cotterless hitch pins.
3. Remove the wood chocks from around the casterwheels.
4. Carefully roll the lift off the shipping pallet and onto the floor.

Preparing the Air Pump for operation

A. Pictogram Definitions



Activating the pump with the pedal end marked with this pictogram, the flow of fluids is directed out of the reservoir.







Activating the pump with the pedal end marked with this pictogram, the flow of fluids is directed back to the reservoir.

B. Air Supply hook up

1. Remove the thread protector from the air inlet of the pump. The pump's air inlet is 1/4-18 NPT internal threads. Select and install the threaded fittings which are compatible with your air supply fittings. The air supply should be 20 CFM (.57 M³/min.) at 100 PSI (7 BAR) at the pump to obtain the rated hydraulic pressure. Air pressure should be regulated to between 50 PSI (3.5 BAR) and 140 PSI (9.5 BAR). A pressure of 100 PSI (7 BAR) is the recommended minimum. Secure your pump fitting to the air supply.
2. It is highly recommended to install an automatic air line oiler to the air supply as close to the pump as possible. Set the unit to feed approximately one drop of oil per minute into the system. Use SAE grade oil, 5W to 30W.

C. Priming the Pump Unit

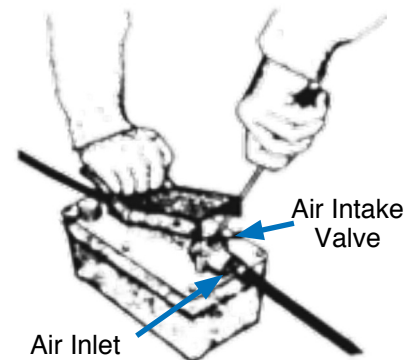

Under certain circumstances it may be necessary to prime the air pump. To accomplish this, perform the following procedure:

1. Press the release end of the pedal while holding down the air intake valve with a flathead screwdriver. The air intake valve is located directly under the pedal in the area marked . The valve is depressed simultaneously with the  area of the pedal during priming.
2. Allow the pump to cycle for approximately 15 seconds.
3. Remove the screwdriver and press  the end of the pedal once more.
4. If the cylinder extends or pressure builds, the pump has been successfully primed. If the pump does not respond, repeat the procedure, jogging the air intake valve while holding the pedal  in position.



Functional check of the Lift

Without external load applied to the lift platform, fully raise and lower the lift multiple times to ensure proper functioning of the hydraulic system and the scissor components.

1. Press the end of the air pump foot pedal  to raise the lift platform until it stops at maximum extension.
2. Press and hold the end of the air pump foot pedal  to lower the lift platform until it reaches full collapse.
3. Ensure platform raises and lowers only when the air pump foot pedal is actively depressed by the operator.

WARNING: To prevent personal injury and/or equipment damage, if platform moves after air pump pedal is released, discontinue use and service immediately.

Preparation of Other Features

A. Platform Tilting

1. Turn the forcing screws in/out fully to ensure proper function of the platform tilting feature. See Fig. 1 of "Fine Adjustment Tilting Feature" section.

B. Stabilisation

1. Insert leveler screws into sockets (approximate 5 turns). Leveler screws should not project above the steel tube or contact the platform underneath when not in use. See Fig. 2 of "Stabilization Feature" section.

B. Platform Sliding Extension

1. Cut the shipping banding securing the platform halves
2. Retract the spring plunger and extend the platform by pulling on the table handle. Ensure the spring plunger engages at all three stop positions when the plunger is released.

Operating Instructions

Fine Adjustment Tilting Feature

The forcing screws shown in Fig. 1 allow the user to finely tilt the platform to help remove or install vehicle components. This feature provides a total of two inches of tilt at the front of the platform which helps compensate for uneven shop floors, difficult fastener locations, etc. The forcing screws can be operated by either hand, wrench or socket, depending on the applied load.

CAUTION: To prevent equipment damage, do not tilt the platform without the leveler screws in their lowest position as the platform might be driven into the screws.

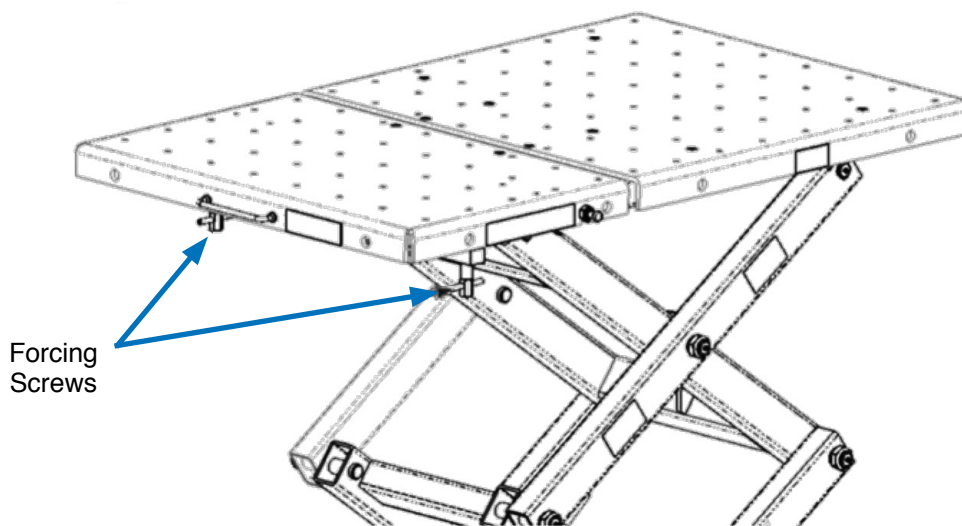

FIG. 1

Stabilisation Feature

If lift is to be used as a stationary work surface for servicing components, two leveler screws (see Fig. 2) have been added to help stabilize the platform.

When the desired tilt or platform position has been reached, thread both leveler screws inward until they meet the bottom of the platform and tighten finger-tight only. This provides two extra points of contact for a more stable platform.

CAUTION: To prevent equipment damage,

- Do not tighten the leveler screws with a wrench or ratchet.
- Do not tilt the table top if the leveler screws are not in their lowest position.

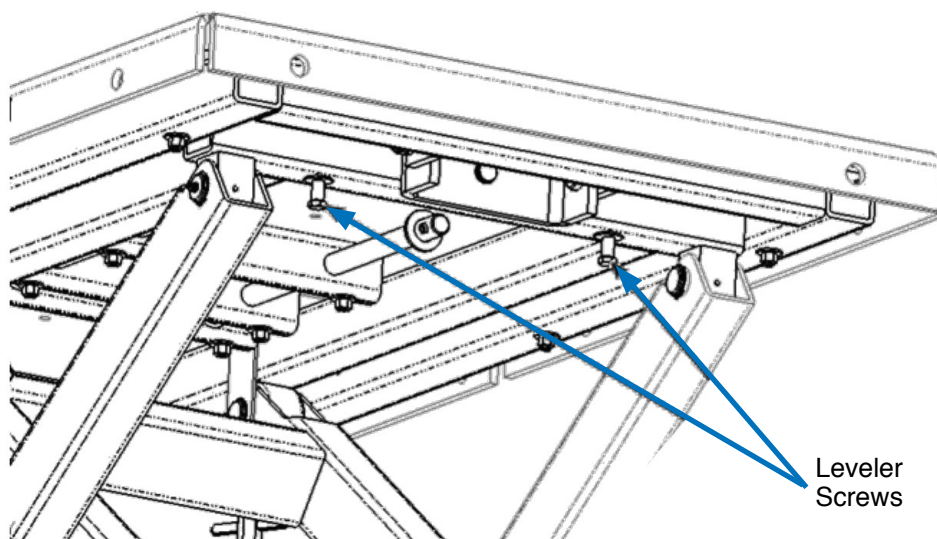

FIG. 2

Platform Sliding Extension Feature

When the lift is to be used as a stationary work surface, the sliding platform extension may be used to facilitate the separation of powertrain components (i.e., engine and transmission). Retract the spring plunger and pull on the Table Handle (See Fig. 3) to extend the sliding platform. Release the spring plunger and slide the platform extension until it locks into a stationary position.

Secure components to the platform with bolts and/or straps. Many M10 x 1.5 holes are provided in the platform top to thread bolts into.

CAUTION: To prevent damaging threads in the platform, do not torque bolts beyond 50 ft. lbs. (68 N•m). Holes in the side edges of the platform are provided for securing the straps.

WARNING: To prevent personal injury and/or equipment damage,

- Always secure components to the platform with bolts and/or straps.
- Do not raise or lower the lift with the platform extended.
- Do not use the Table Handle (located on the sliding platform) to move the entire lift.

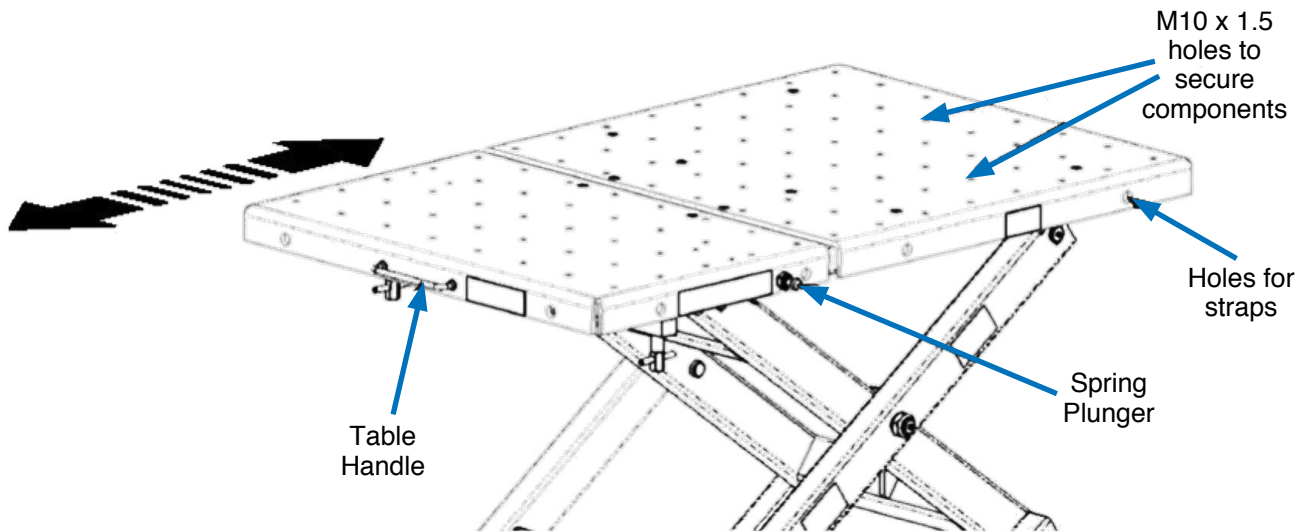





FIG. 3

Operating the Lift to remove components

1. Always follow the vehicle manufacturer's recommended service procedure for removal of the component.
2. Position the lift under the vehicle. Connect the air hose to the air pump.
3. Press the end of air pump foot pedal  to raise the lift to the load.
4. Remove any remaining bolts from the vehicle component.
5. Press the end of the air pump foot pedal  and lower the lift completely.
6. Move the lift and load out from under the vehicle.

Operating the Lift to install components

1. Position the lift under the vehicle chassis.
2. Align the component in the correct position and press the end of the air pump foot pedal  to raise the lift.
3. Always follow the vehicle manufacturer's recommended service procedure for installing the component.

Inspection and Maintenance

CAUTION: To prevent personal injury,

- Only qualified personnel shall perform inspections and repairs to this lift.
- Before each use, inspect the lift for bends, cracks, dents, elongated holes, or missing hardware. If damage is found, discontinue use.
- Use only those repair parts called out in the parts list in this document. Items found in the parts list have been carefully tested and selected.

Inspection

Before each use, an approved inspector must inspect the lift for bends, cracks, dents, elongated holes, or missing hardware. If damage is found, discontinue use.

Repair

When repairing the lift, use only those repair parts called out in the parts list in this document.

Disposal

At the end of the useful life of the lift, dispose of the components according to all state, federal, and local regulations.

Preventive Maintenance

NOTE: 1 cycle = 1 complete raising and lowering of the lift platform.
Every 300 cycles or 6 months, whichever comes first.

A. Hydraulic Cylinder

1. Inspect for hydraulic fluid leaks.
 - Some oil accumulation on the cylinder rod is normal and desired for proper functioning of the unit.
 - If fluid is escaping and leaking on the floor, the cylinder requires servicing.
2. Without a load applied to the platform, raise and lower the lift multiple times.
If the cylinder pulses, sticks, or generally doesn't operate smoothly, the unit needs servicing.

B. Hydraulic Fittings

1. Inspect for leaks.
 - Tighten fittings to stop leak.
 - Replace fittings if tightening does not stop leak.

C. Hose

1. Inspect and replace if found to contain cuts, cracks, or considerable surface wear.

D. Pump

1. Check hydraulic fluid level.
 - The fluid level should be 1/2 inch (12.7 mm) from the filler/vent cap with the cylinder retracted.
Replenish with hydraulic fluid (P/N 9637) through this port if needed.
2. Check pump reservoir for leaks due to damage to reservoir.
3. Raise and lower the platform by operating the air pump pedal.
Ensure the platform raises and lowers only when the air pump pedal is actuated.

WARNING: To prevent personal injury and/or equipment damage, discontinue use and service of the unit immediately if the platform moves after air pump pedal is released.

3. If the platform moves slowly when raising, or pump seems to reciprocate faster than normal, install an automatic air line oiler prior to the pump.
 - When the automatic air line oiler is installed, some oil discharge from the pump exhaust is normal and indicates proper lubrication.

E. Lubrication

1. Use a grease gun to thoroughly apply grease at every location fitted with grease fittings (i.e., upper & lower rollers, casters, scissor & hydraulic cylinder pivot pins, etc.). Pump grease into fitting until only new grease can be seen escaping from joint. Wipe away excess.

F. Cleaning

1. Wipe dirt, debris and grime from all surfaces using a clean rag.

Every 3000 cycles or 24 months, whichever comes first:

A. Draining and Flushing the Pump Reservoir

1. Remove the screws that fasten the pump assembly to the reservoir. Remove the pump assembly from the reservoir. Do not damage the gasket, filter or safety valve.
2. Drain the reservoir of all fluid and refill to half full with clean hydraulic fluid (P/N 9637). Rinse the filter clean.
3. Place the pump assembly back onto the reservoir, and secure with two machine screws assembled in opposite corners of the housing.
4. Run the unit for several minutes. Use the same method described in section titled "Priming the Pump Unit."
5. Drain and clean the reservoir once more.
6. Refill the reservoir with hydraulic fluid (p/n 9637) and replace the pump assembly (with gasket) on the reservoir and install the screws. Torque screws to 25 to 30 inch pounds (2.8 to 3.4N•m).

B. Refilling the Pump Reservoir

1. If additional fluid must be added to the reservoir, use only hydraulic fluid (p/n 9637; 215 SSU @ 38° C). Clean the entire area around the filler plug before adding fluid to the reservoir. Remove the filler plug and insert a clean funnel with the filter. The cylinder must be fully retracted and air supply disconnected when adding fluid to the reservoir.

Parts and Drawing Breakdown for AA49010

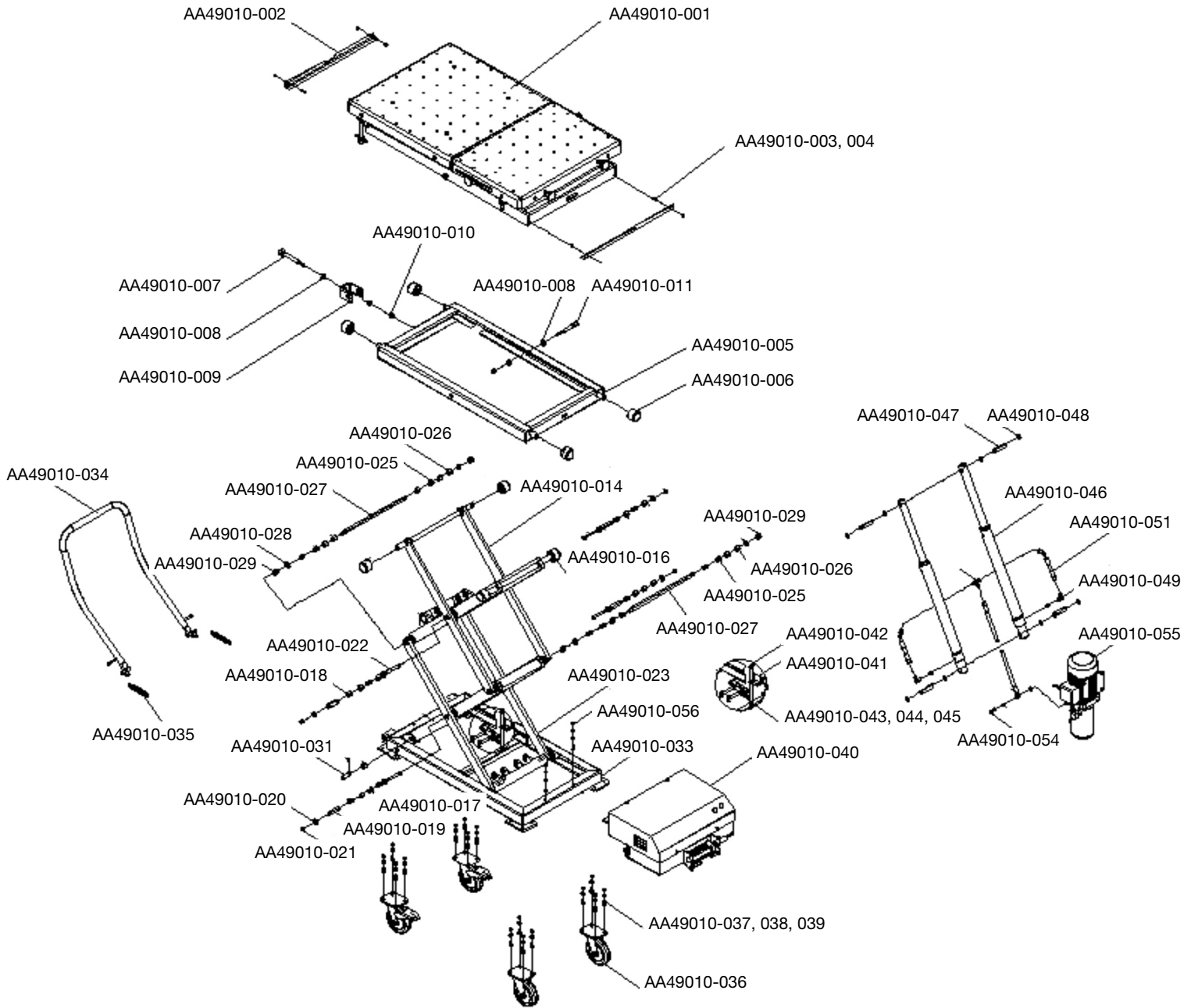

NSW/ACT

TEL: (02) 9677 1555
FAX: (02) 9675 1155

QLD/PNG

TEL: (07) 3204 9166
FAX: (07) 3204 1224

VIC/TAS

TEL: (03) 8787 8288
FAX: (03) 8787 8266

WA

TEL: (08) 9302 4199
FAX: (08) 9303 2095

SA/NT

TEL: (08) 8241 7111
FAX: (08) 8241 7011

NZ

TEL: (09) 447 1007
FAX: (09) 447 1008

Ordering Spare Parts

Parts List – Part No. AA49010

Alemlube No.	Name	Qty
AA49010-001	Upper platform	1
AA49010-002	Small angle iron	2
AA49010-003	Bolt M6*16	4
AA49010-004	Self-locking nut M6	4
AA49010-005	Platform frame	1
AA49010-006	Roller	4
AA49010-007	Threaded rod	1
AA49010-008	Bearing	4
AA49010-009	Connecting base	1
AA49010-010	Self-locking nut M12	2
AA49010-011	Short threaded rod	1
AA49010-012	Shaft	1
AA49010-013	Roller	2
AA49010-014	Scissor 04	2
AA49010-015	Scissor 02	1
AA49010-016	Roller	4
AA49010-017	Composite bush P23*20*14	8
AA49010-018	Composite bush P23*20*20	8
AA49010-019	Shaft sleeve	4
AA49010-020	Washer 10	8
AA49010-021	Self-locking nut M10	4
AA49010-022	Bolt M10*90	4
AA49010-023	Scissor 03	1
AA49010-024	Scissor 01	1
AA49010-025	Composite bush P23*20*14	8
AA49010-026	Composite bush P23*20*20	8
AA49010-027	Double thread screw	2
AA49010-028	Washer 16	4
AA49010-029	Self-locking nut M16	4
AA49010-030	Composite bush P23*20*20	2

Alemlube No.	Name	Qty
AA49010-031	Chassis spindle	2
AA49010-032	Screw M6*12	2
AA49010-033	Base frame	1
AA49010-034	Handle	1
AA49010-035	Spring	2
AA49010-036	Truckle	4
AA49010-037	Bolt M10*20	16
AA49010-038	Washer 10	16
AA49010-039	Elastic washer 10	16
AA49010-040	Hydraulic box	1
AA49010-041	Travel switch angle iron	1
AA49010-042	Bolt M6*10	2
AA49010-043	Travel switch	1
AA49010-044	Screw M4*12	2
AA49010-045	Screw M4*25	2
AA49010-046	Cylinder	2
AA49010-047	Shaft	4
AA49010-048	Shield ring 10	8
AA49010-049	Connector	1
AA49010-050	Connector	1
AA49010-051	High pressure hose L=160	2
AA49010-052	High pressure hose L=1300	1
AA49010-053	Composite bush	2
AA49010-054	Short pressing bolt	1
AA49010-055	Pump	1
AA49010-056	Bolt M8*20	2
AA49010-057	Elastic washer 8	2
AA49010-058	Washer 8	2
AA49010-059	Nut M8	2

NSW/ACT

TEL: (02) 9677 1555
FAX: (02) 9675 1155

QLD/PNG

TEL: (07) 3204 9166
FAX: (07) 3204 1224

VIC/TAS

TEL: (03) 8787 8288
FAX: (03) 8787 8266

WA

TEL: (08) 9302 4199
FAX: (08) 9303 2095

SA/NT

TEL: (08) 8241 7111
FAX: (08) 8241 7011

NZ

TEL: (09) 447 1007
FAX: (09) 447 1008

Parts and Drawing Breakdown for AA49010

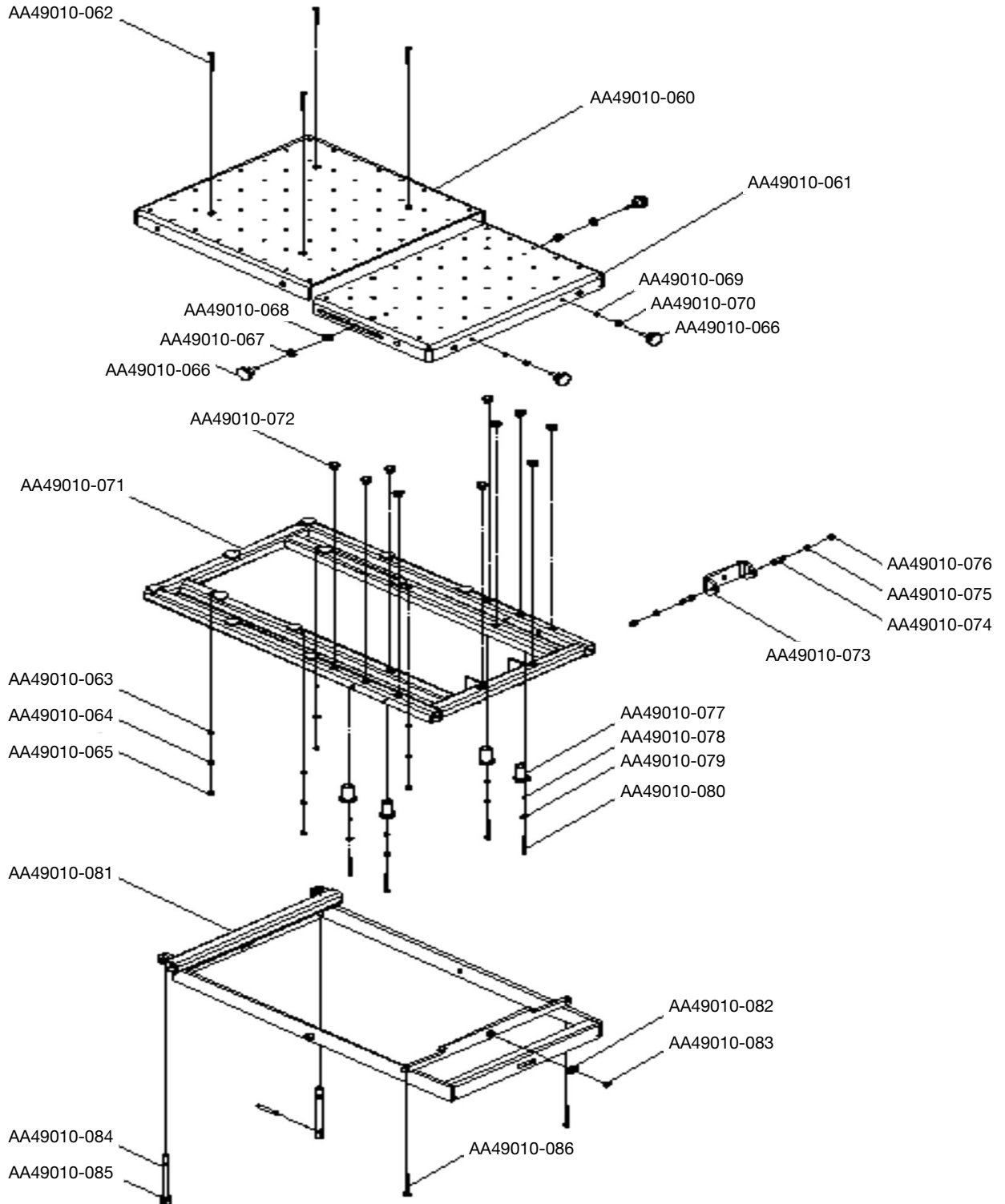

NSW/ACT

TEL: (02) 9677 1555
FAX: (02) 9675 1155

QLD/PNG

TEL: (07) 3204 9166
FAX: (07) 3204 1224

VIC/TAS

TEL: (03) 8787 8288
FAX: (03) 8787 8266

WA

TEL: (08) 9302 4199
FAX: (08) 9303 2095

SA/NT

TEL: (08) 8241 7111
FAX: (08) 8241 7011

NZ

TEL: (09) 447 1007
FAX: (09) 447 1008

Ordering Spare Parts

Parts List – Part No. AA49010

Alemlube No.	Name	Qty
AA49010-060	Platform A	1
AA49010-061	Platfor B	1
AA49010-062	Screw M8*80	4
AA49010-063	Elastic washer 8	4
AA49010-064	Washer 8	4
AA49010-065	Nut M8	4
AA49010-066	Handle	4
AA49010-067	Washer 10	2
AA49010-068	Sleeve C	2
AA49010-069	Elastic washer 10	2
AA49010-070	Self-locking nut M10	2
AA49010-071	Upper platform weldment	1
AA49010-072	Bearing	10
AA49010-073	U shape board	1

Alemlube No.	Name	Qty
AA49010-074	Screw 13*25	2
AA49010-075	Washer 10	2
AA49010-076	Self-locking nut M10	2
AA49010-077	Eccentric bushing	4
AA49010-078	Elastic washer 8	4
AA49010-079	Washer 8	4
AA49010-080	Bolt M8*80	4
AA49010-081	Down platform weldment	1
AA49010-082	Washer 18	1
AA49010-083	Shield ring 19	1
AA49010-084	Bolt	2
AA49010-085	Round pin 10*80	2
AA49010-086	Bolt M10*90	2

NSW/ACT

TEL: (02) 9677 1555
FAX: (02) 9675 1155

QLD/PNG

TEL: (07) 3204 9166
FAX: (07) 3204 1224

VIC/TAS

TEL: (03) 8787 8288
FAX: (03) 8787 8266

WA

TEL: (08) 9302 4199
FAX: (08) 9303 2095

SA/NT

TEL: (08) 8241 7111
FAX: (08) 8241 7011

NZ

TEL: (09) 447 1007
FAX: (09) 447 1008

Parts and Drawing Breakdown for AA49010

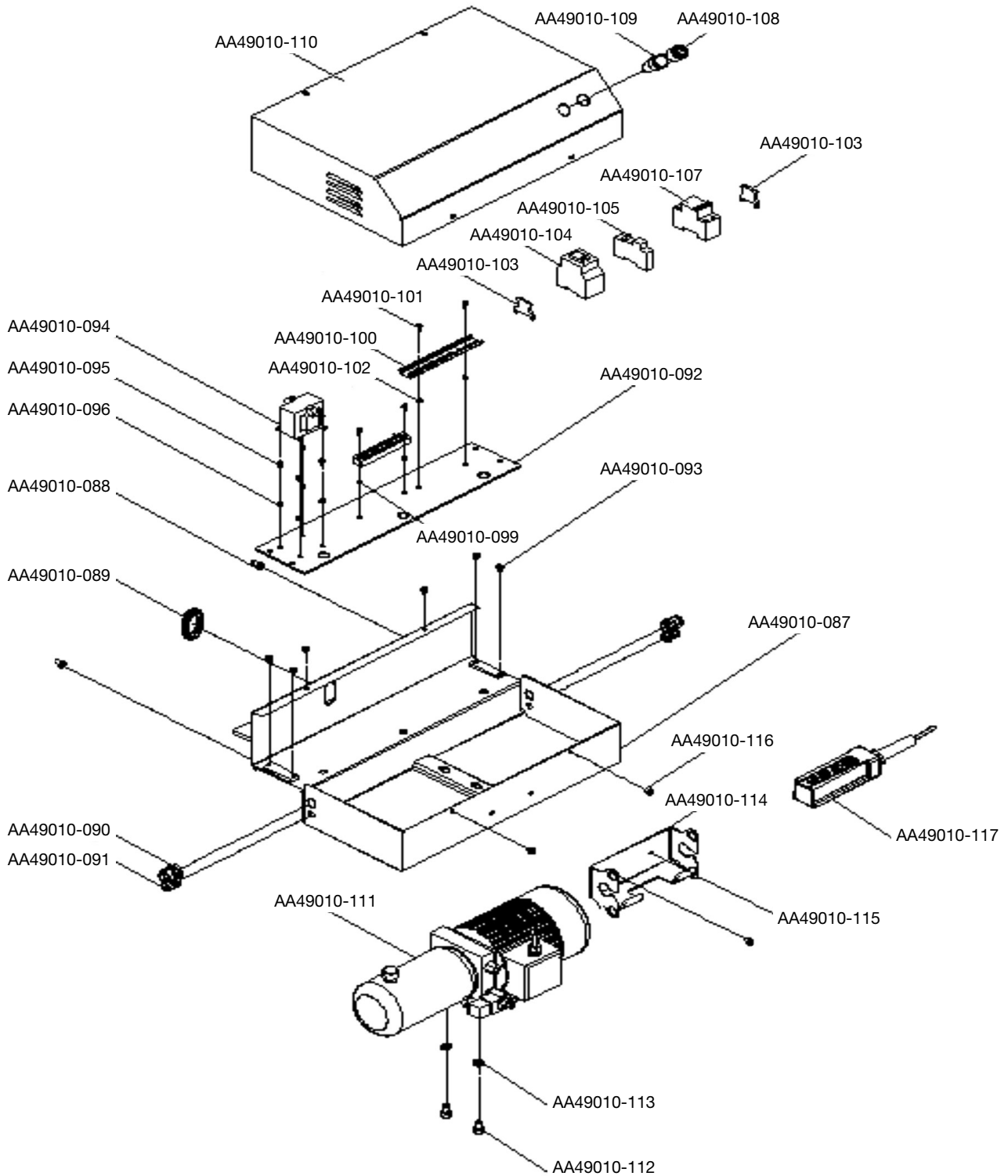

NSW/ACT

TEL: (02) 9677 1555
FAX: (02) 9675 1155

QLD/PNG

TEL: (07) 3204 9166
FAX: (07) 3204 1224

VIC/TAS

TEL: (03) 8787 8288
FAX: (03) 8787 8266

WA

TEL: (08) 9302 4199
FAX: (08) 9303 2095

SA/NT

TEL: (08) 8241 7111
FAX: (08) 8241 7011

NZ

TEL: (09) 447 1007
FAX: (09) 447 1008

Ordering Spare Parts

Parts List – Part No. AA49010

Alemlube No.	Name	Qty
AA49010-087	Hydraulic pump box	1
AA49010-088	Bolt M8*16	2
AA49010-089	Protection of hydraulic hose	1
AA49010-090	Wire grip PG 13.5	2
AA49010-091	Wire grip PG 7	2
AA49010-092	Installation board	1
AA49010-093	Screw M6*8	4
AA49010-094	Transformer	1
AA49010-095	Screw M5*8	4
AA49010-096	Nut M5	4
AA49010-097	Line row	1
AA49010-098	Screw M4*10	2
AA49010-099	Nut M4	2
AA49010-100	Clip orbit 140mm	1
AA49010-101	Screw M4*10	2
AA49010-102	Nut M4	2

Alemlube No.	Name	Qty
AA49010-103	Yellow green terminal	2
AA49010-104	AC contactor	1
AA49010-105	Fuse base	1
AA49010-106	Fuse 6A	1
AA49010-107	Breaker	1
AA49010-108	Buzzer	1
AA49010-109	Indicator light	1
AA49010-110	Cover of hydraulic box	1
AA49010-111	Pump	1
AA49010-112	Bolt M10*16	2
AA49010-113	Washer 10	2
AA49010-114	Button base	1
AA49010-115	Screw M6*10	2
AA49010-116	Screw M6*8	4
AA49010-117	Button	1

NSW/ACT

TEL: (02) 9677 1555
FAX: (02) 9675 1155

QLD/PNG

TEL: (07) 3204 9166
FAX: (07) 3204 1224

VIC/TAS

TEL: (03) 8787 8288
FAX: (03) 8787 8266

WA

TEL: (08) 9302 4199
FAX: (08) 9303 2095

SA/NT

TEL: (08) 8241 7111
FAX: (08) 8241 7011

NZ

TEL: (09) 447 1007
FAX: (09) 447 1008

Parts and Drawing Breakdown for AA49010

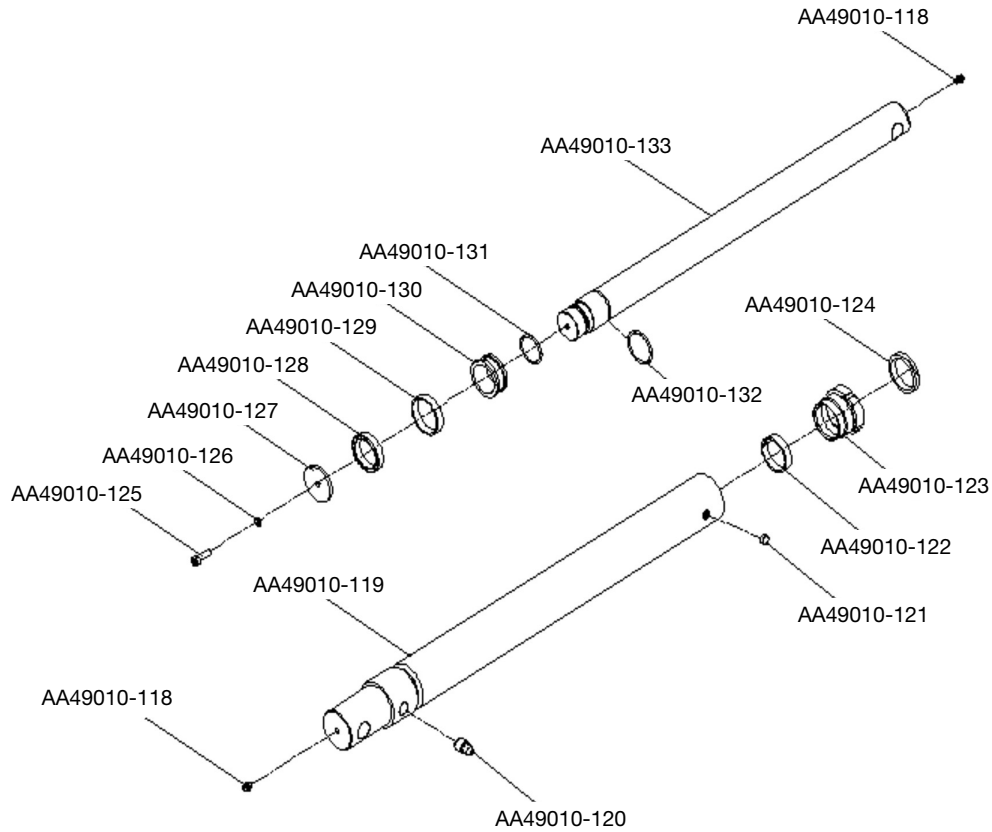

Ordering Spare Parts

Parts List – Part No. AA49010

Alemlube No.	Name	Qty
AA49010-118	Priming cup M6*1	2
AA49010-119	Cylinder case	1
AA49010-120	Throttle vavle	1
AA49010-121	Pneumostome φ10	1
AA49010-122	Wear ring for shaft T47	1
AA49010-123	Guide sleeve	1
AA49010-124	Dustband	1
AA49010-125	Screw M6*20	1

Alemlube No.	Name	Qty
AA49010-126	Elastic washer 6	1
AA49010-127	Washer	1
AA49010-128	Seal	1
AA49010-129	Wear ring for hole T47	1
AA49010-130	Piston	1
AA49010-131	O-ring	1
AA49010-132	Shield ring 38	1
AA49010-133	Piston rod	1

NSW/ACT
TEL: (02) 9677 1555
FAX: (02) 9675 1155

QLD/PNG
TEL: (07) 3204 9166
FAX: (07) 3204 1224

VIC/TAS
TEL: (03) 8787 8288
FAX: (03) 8787 8266

WA
TEL: (08) 9302 4199
FAX: (08) 9303 2095

SA/NT
TEL: (08) 8241 7111
FAX: (08) 8241 7011

NZ
TEL: (09) 447 1007
FAX: (09) 447 1008

Parts and Drawing Breakdown for AA49010

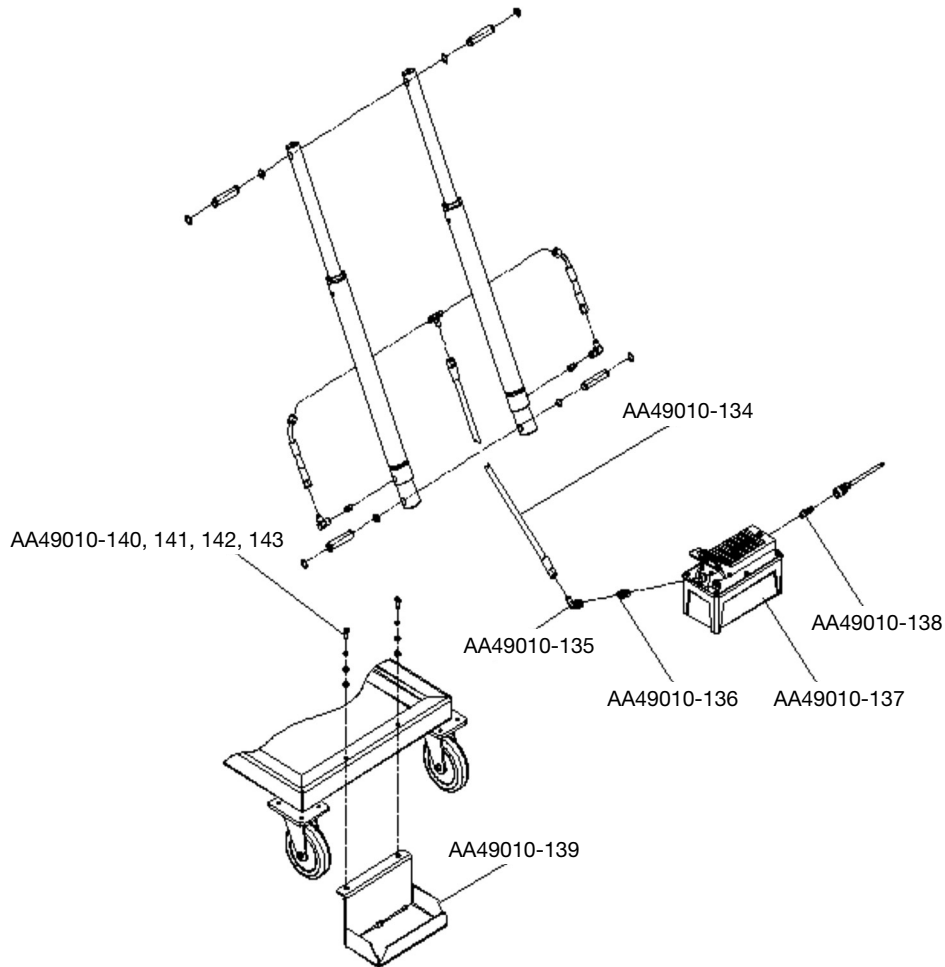

Ordering Spare Parts

Parts List – Part No. AA49010

Alemlube No.	Name	Qty
AA49010-134	High pressure L=1300	1
AA49010-135	90 degree square bent M14*1.5	1
AA49010-136	Straight joint	1
AA49010-137	Air pump	1
AA49010-138	Connector	1

Alemlube No.	Name	Qty
AA49010-139	Support of the air pump	1
AA49010-140	Nut M8*20	2
AA49010-141	Elastic washer 8	2
AA49010-142	Washer 8	2
AA49010-143	Nut M8	2

NSW/ACT

TEL: (02) 9677 1555
FAX: (02) 9675 1155

QLD/PNG

TEL: (07) 3204 9166
FAX: (07) 3204 1224

VIC/TAS

TEL: (03) 8787 8288
FAX: (03) 8787 8266

WA

TEL: (08) 9302 4199
FAX: (08) 9303 2095

SA/NT

TEL: (08) 8241 7111
FAX: (08) 8241 7011

NZ

TEL: (09) 447 1007
FAX: (09) 447 1008